

Dates:
 NOV 05, 2012
 May 14, 2013
 JUNE 17, 2013
 August 30, 2013
 Nov. 11, 2013
 Jan. 03, 2014
 August 08, 2014
 July 31, 2015
 SEPTEMBER 21, 2015
 October 19, 2016
 April 17, 2017

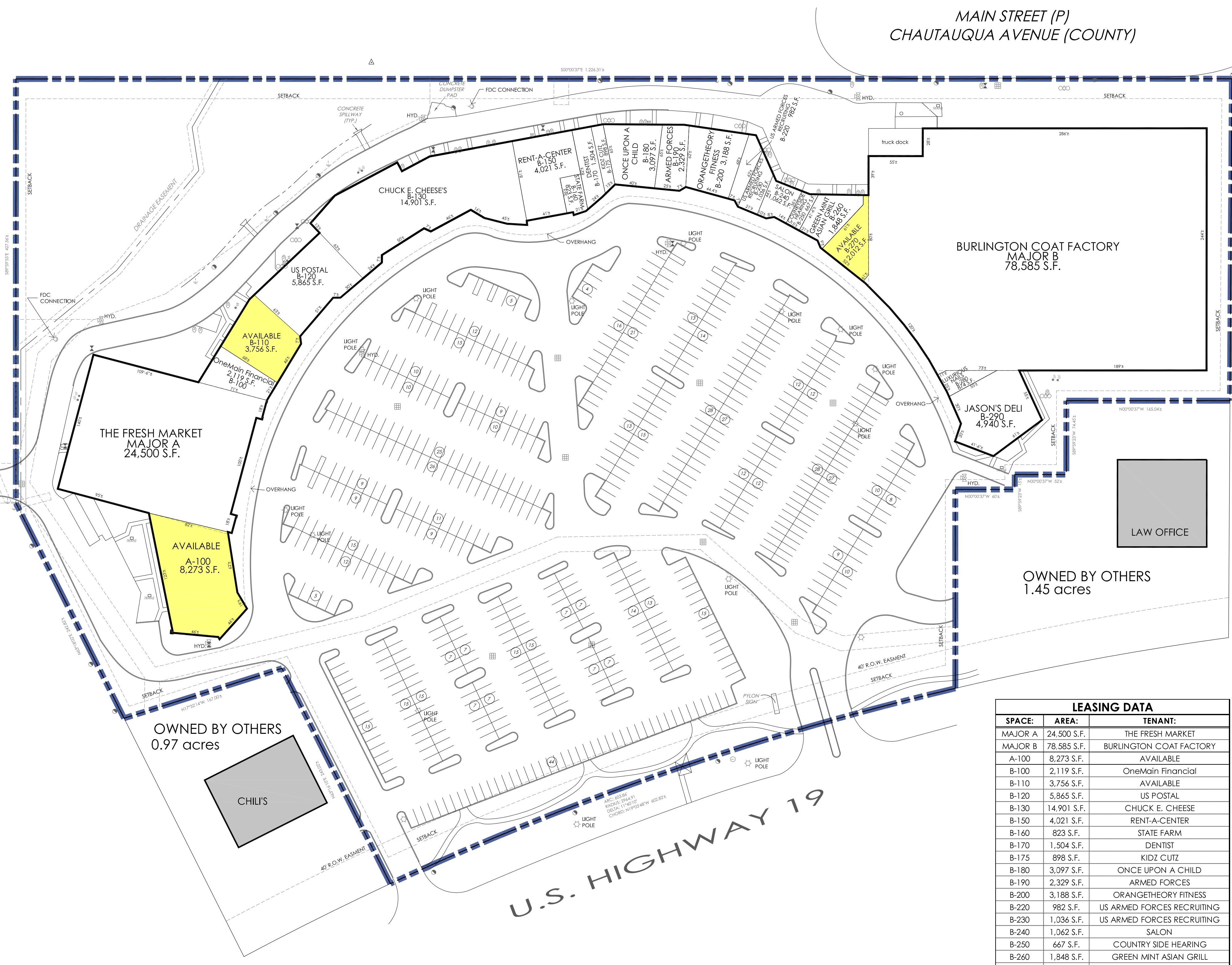
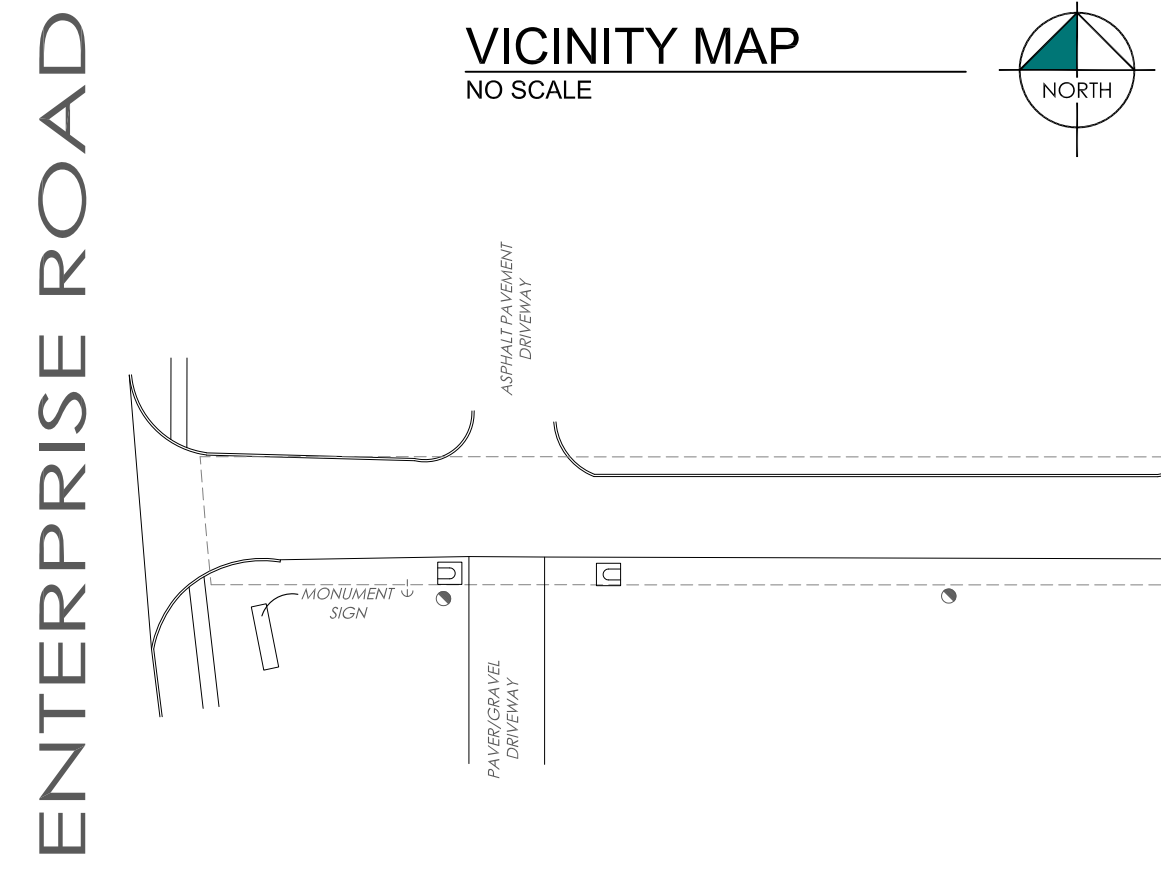
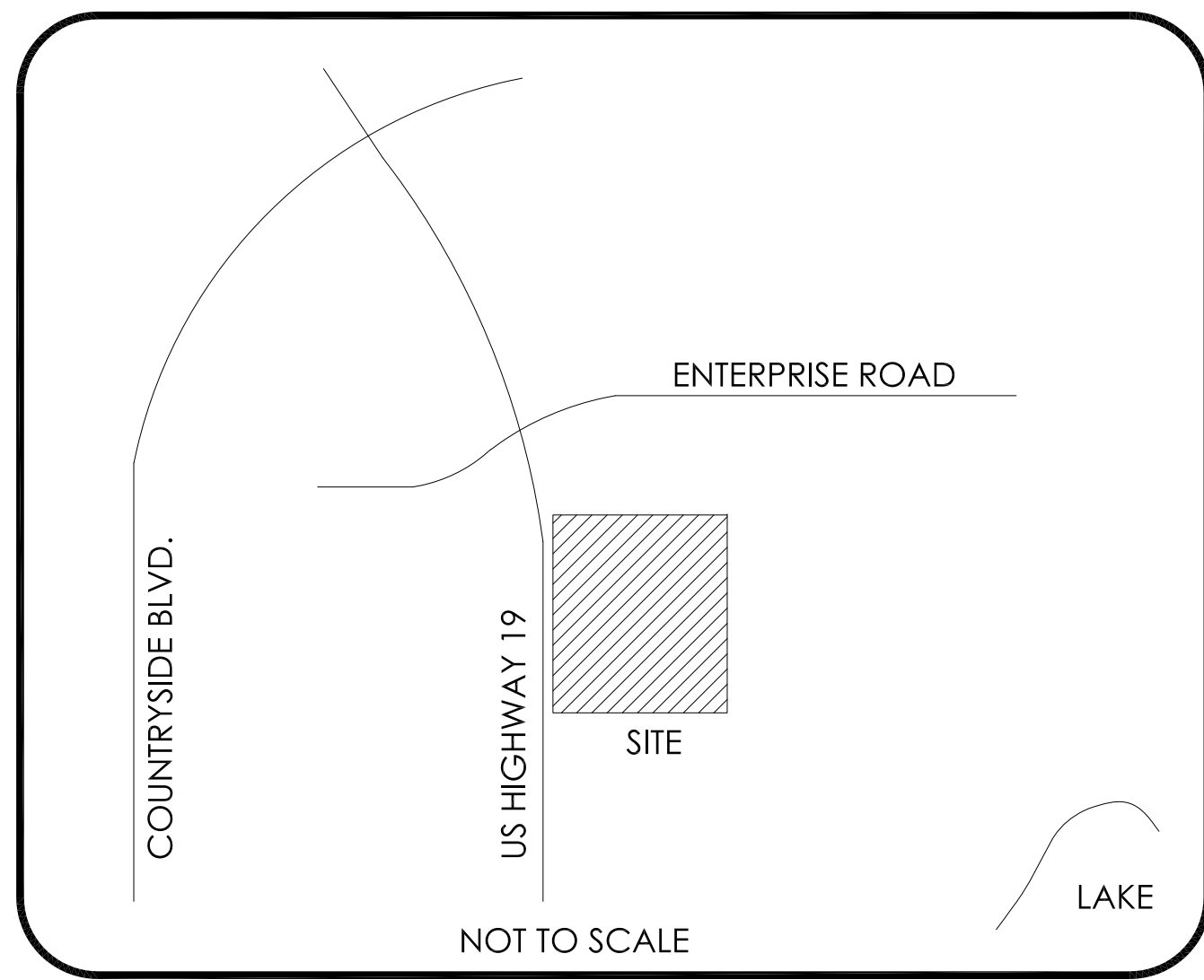

LEASING DATA		
SPACE:	AREA:	TENANT:
MAJOR A	24,500 S.F.	THE FRESH MARKET
MAJOR B	78,585 S.F.	BURLINGTON COAT FACTORY
A-100	8,273 S.F.	AVAILABLE
B-100	2,119 S.F.	OneMain Financial
B-110	3,756 S.F.	AVAILABLE
B-120	5,865 S.F.	US POSTAL
B-130	14,901 S.F.	CHUCK E. CHEESE
B-150	4,021 S.F.	RENT-A-CENTER
B-160	823 S.F.	STATE FARM
B-170	1,504 S.F.	DENTIST
B-175	898 S.F.	KIDZ CUTZ
B-180	3,097 S.F.	ONCE UPON A CHILD
B-190	2,329 S.F.	ARMED FORCES
B-200	3,188 S.F.	ORANGETHEORY FITNESS
B-220	982 S.F.	US ARMED FORCES RECRUITING
B-230	1,036 S.F.	US ARMED FORCES RECRUITING
B-240	1,062 S.F.	SALON
B-250	667 S.F.	COUNTRY SIDE HEARING
B-260	1,848 S.F.	GREEN MINT ASIAN GRILL
B-270	2,012 S.F.	AVAILABLE
B-280	874 S.F.	LUXURIOUS NAILS
B-290	4,940 S.F.	JASON'S DELI

TOTALS:	
MAJOR A	24,500 S.F.
MAJOR B	78,585 S.F.
RETAIL A	8,273 S.F.
RETAIL B	55,922 S.F.
TOTAL	167,280 S.F.
TOTAL PARKING	700 SPACES
PARKING RATIO	4.18/1000
LAND AREA	
RGPT OWNED	±16.835 A.C.
OWNED BY OTHERS	±2.420 A.C.
TOTAL	±19.255 A.C.

AVAILABLE LEASED

LEASE/SITE PLAN
SCALE: 1" = 60'

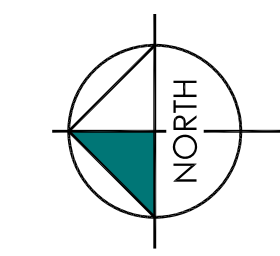
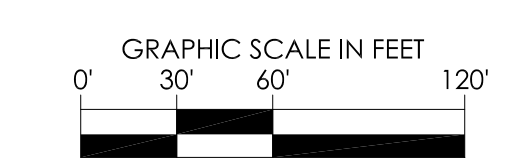

Footnotes:
Zoning: - Commercial General

CIVIL DATA: ALTA SURVEY DATED 12-04-2006 INTERNATIONAL LAND SERVICES, INC.

DISCLAIMER

LEASE/SITE PLAN

Project
CYPRESS POINT
CLEARWATER
FLORIDA

RAMCO
GERSHENSON
PROPERTIES TRUST

Center Number
439-01
Sheet Number
LS-35
AVAILABILITY

THIS DRAWING IS ILLUSTRATIVE AND FOR INFORMATION ONLY. IT IS NOT TO BE USED FOR CONSTRUCTION. ALL DIMENSIONS AND QUANTITIES ARE SUBJECT TO THE VERIFICATION BY THE ENGINEER. THE ENGINEER SHALL BE RESPONSIBLE FOR THE ACCURACY OF THE INFORMATION PROVIDED. THE ENGINEER SHALL BE RESPONSIBLE FOR THE ACCURACY OF THE INFORMATION PROVIDED. THE ENGINEER SHALL BE RESPONSIBLE FOR THE ACCURACY OF THE INFORMATION PROVIDED.